

Misure tecniche Misure in mm - Riserva di modifiche senza preavviso

DPC

Cappa antivento modello C

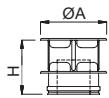

| Ø | 100 | 130 | 150 | 180 | 200 | 250 |
|----|-----|-----|-----|-----|-----|-----|
| ØA | 200 | 300 | 300 | 420 | 420 | 500 |
| H | 160 | 190 | 220 | 260 | 290 | 340 |

DPCA

Cappa antivento a botte

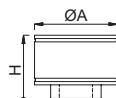

| Ø | 80 | 100 | 130 | 150 | 180 | 200 | 250 | 300 |
|----|-----|-----|-----|-----|-----|-----|-----|-----|
| ØA | 230 | 250 | 300 | 300 | 350 | 350 | 400 | 450 |
| H | 310 | 310 | 310 | 310 | 310 | 310 | 310 | 310 |

DPTC

Terminale conico



| Ø | 80 | 100 | 130 | 150 | 180 | 200 | 250 | 300 |
|---|-----|-----|-----|-----|-----|-----|-----|-----|
| H | 190 | 190 | 190 | 190 | 190 | 190 | 190 | 190 |

DPLA

Cappa con lamelle

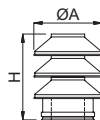

| Ø | 100 | 150 | 200 | 250 |
|----|-----|-----|-----|-----|
| ØA | 205 | 235 | 270 | 400 |
| H | 310 | 290 | 370 | 390 |

DP100 / DP50 / DP30 / DP25

Diritto 940/440/270/190 mm utili

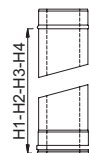

| Ø | 80 | 100 | 130 | 150 | 180 | 200 | 250 | 300 |
|----|-----|-----|-----|-----|-----|-----|-----|-----|
| H1 | 940 | 940 | 940 | 940 | 940 | 940 | 940 | 940 |
| H2 | 440 | 440 | 440 | 440 | 440 | 440 | 440 | 440 |
| H3 | 270 | 270 | 270 | 270 | 270 | 270 | 270 | 270 |
| H4 | 190 | 190 | 190 | 190 | 190 | 190 | 190 | 190 |

DPR

Elemento regolabile 260-380 mm.

Elemento telescopico che consente di coprire misure variabili fino a 120 mm. Utilizzabile solo con fumi secchi e in depressione. Se installato in verticale inserire un supporto sopra l'elemento

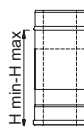

| Ø | 100 | 130 | 150 | 180 | 200 | 250 | 300 |
|-------|-----|-----|-----|-----|-----|-----|-----|
| H min | 260 | 260 | 260 | 260 | 260 | 260 | 260 |
| H max | 380 | 380 | 380 | 380 | 380 | 380 | 380 |

DPT87

Elemento a T 87°

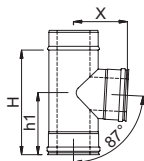

| Ø | 80 | 100 | 130 | 150 | 180 | 200 | 250 | 300 |
|----|-----|-----|-----|-----|-----|-----|-----|-----|
| H | 440 | 440 | 440 | 440 | 440 | 440 | 440 | 440 |
| h1 | 245 | 245 | 245 | 245 | 245 | 245 | 245 | 245 |
| X | 145 | 155 | 170 | 180 | 195 | 210 | 235 | 260 |

DPTR80

Elemento a T 87° ridotto a 80 mm.

Derivazione con uscita maschio monoparete

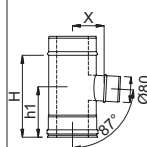

| Ø | 100 | 130 | 150 | 180 | 200 | 250 |
|----|-----|-----|-----|-----|-----|-----|
| H | 270 | 270 | 270 | 270 | 270 | 270 |
| h1 | 163 | 163 | 163 | 163 | 163 | 163 |
| X | 105 | 120 | 130 | 145 | 155 | 180 |

DPT45

Elemento a T 45°

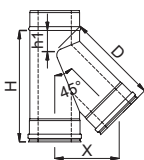

| Ø | 130 | 150 | 180 | 200 | 250 | 300 |
|----|-----|-----|-----|-----|-----|-----|
| H | 440 | 440 | 490 | 490 | 590 | 645 |
| h1 | 105 | 75 | 95 | 90 | 120 | 130 |
| D | 360 | 375 | 400 | 415 | 475 | 535 |
| X | 255 | 265 | 280 | 295 | 335 | 380 |

DPG87

Gomito a 87°

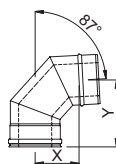

| Ø | 80 | 100 | 130 | 150 | 180 | 200 | 250 | 300 |
|---|-----|-----|-----|-----|-----|-----|-----|-----|
| X | 115 | 110 | 105 | 135 | 155 | 160 | 185 | 215 |
| Y | 175 | 180 | 170 | 200 | 200 | 225 | 250 | 270 |

DPG45

Gomito a 45°

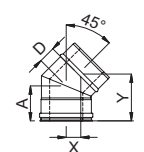

| Ø | 80 | 100 | 130 | 150 | 180 | 200 | 250 | 300 |
|---|-----|-----|-----|-----|-----|-----|-----|-----|
| A | 100 | 105 | 110 | 115 | 125 | 130 | 140 | 150 |
| D | 45 | 50 | 60 | 60 | 70 | 75 | 85 | 90 |

DPG30

Gomito a 30°

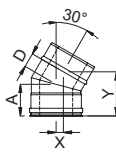

| Ø | 80 | 100 | 130 | 150 | 180 | 200 | 250 | 300 |
|---|----|-----|-----|-----|-----|-----|-----|-----|
| A | 90 | 95 | 100 | 100 | 105 | 105 | 115 | 120 |
| D | 40 | 40 | 45 | 45 | 50 | 55 | 60 | 70 |

DISASSAMENTI DPG45

Per ulteriori spostamenti consultare l'Ufficio Tecnico G.B.D

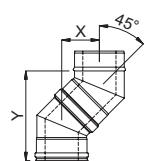

| Ø | 80 | 100 | 130 | 150 | 180 | 200 | 250 | 300 | |
|-------------------|----|-----|-----|-----|-----|-----|------|------|------|
| n.2 DPG45 | X | 103 | 110 | 120 | 124 | 138 | 145 | 159 | 170 |
| | Y | 248 | 265 | 290 | 299 | 333 | 350 | 384 | 410 |
| n.2 DPG45 + DP25 | X | 237 | 244 | 255 | 258 | 272 | 279 | 293 | 304 |
| | Y | 382 | 399 | 425 | 433 | 467 | 484 | 518 | 544 |
| n.2 DPG45 + DP30 | X | 293 | 300 | 311 | 315 | 329 | 336 | 350 | 361 |
| | Y | 438 | 455 | 481 | 490 | 524 | 541 | 575 | 601 |
| n.2 DPG45 + DP50 | X | 414 | 421 | 431 | 435 | 449 | 456 | 470 | 481 |
| | Y | 559 | 576 | 601 | 610 | 644 | 661 | 695 | 721 |
| n.2 DPG45 + DP100 | X | 767 | 774 | 785 | 788 | 802 | 810 | 824 | 834 |
| | Y | 912 | 929 | 955 | 963 | 997 | 1015 | 1049 | 1074 |

DISASSAMENTI DPG30

Per ulteriori spostamenti consultare l'Ufficio Tecnico G.B.D

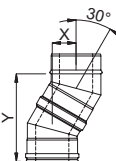

| Ø | 80 | 100 | 130 | 150 | 180 | 200 | 250 | 300 | |
|-------------------|----|------|------|------|------|------|------|------|------|
| n.2 DPG30 | X | 65 | 68 | 73 | 73 | 78 | 80 | 88 | 95 |
| | Y | 243 | 252 | 271 | 271 | 289 | 299 | 327 | 355 |
| n.2 DPG30 + DP25 | X | 160 | 163 | 168 | 168 | 173 | 175 | 183 | 190 |
| | Y | 407 | 416 | 435 | 435 | 454 | 463 | 491 | 519 |
| n.2 DPG30 + DP30 | X | 200 | 203 | 208 | 208 | 213 | 215 | 223 | 230 |
| | Y | 476 | 486 | 504 | 504 | 523 | 532 | 560 | 588 |
| n.2 DPG30 + DP50 | X | 285 | 288 | 293 | 293 | 298 | 300 | 308 | 315 |
| | Y | 624 | 633 | 652 | 652 | 670 | 680 | 708 | 736 |
| n.2 DPG30 + DP100 | X | 535 | 538 | 543 | 543 | 548 | 550 | 558 | 565 |
| | Y | 1057 | 1066 | 1085 | 1085 | 1103 | 1113 | 1141 | 1169 |

Misure tecniche Misure in mm - Riserva di modifiche senza preavviso

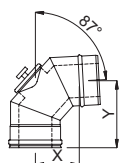

DPGI87

Gomito a 87° ispezionabile.
Temperatura massima di utilizzo 200 °C

| Ø | 100 | 130 | 150 | 180 | 200 | 250 | 300 |
|---|-----|-----|-----|-----|-----|-----|-----|
| X | 110 | 105 | 135 | 155 | 160 | 185 | 215 |
| Y | 180 | 170 | 200 | 200 | 225 | 250 | 270 |

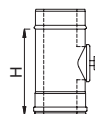

DPIT

Ispezione con tappo.
Per combustibili gassosiliquidipellet

| Ø | 80 | 100 | 130 | 150 | 180 | 200 | 250 | 300 |
|---|-----|-----|-----|-----|-----|-----|-----|-----|
| H | 270 | 270 | 270 | 270 | 270 | 270 | 270 | 270 |

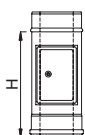

DPIS

Ispezione per combustibili solidi

| Ø | 130 | 150 | 180 | 200 | 250 | 300 |
|---|-----|-----|-----|-----|-----|-----|
| H | 440 | 440 | 440 | 440 | 440 | 440 |



DPTAPPO

Tappo cieco.
Elemento dotato di maniglia

| Ø | 100 | 130 | 150 | 180 | 200 | 250 | 300 |
|---|-----|-----|-----|-----|-----|-----|-----|
| H | 25 | 25 | 25 | 25 | 25 | 25 | 25 |



DPPF

Prelievo fumi.
Elemento provvisto di foro per l'inserimento di sonde, fornito con tappo

| Ø | 80 | 100 | 130 | 150 | 180 | 200 | 250 | 300 |
|---|-----|-----|-----|-----|-----|-----|-----|-----|
| H | 190 | 190 | 190 | 190 | 190 | 190 | 190 | 190 |



DPPT

Prelievo fumi con termometro.
Termometro con gambo inox 0+500 °C. Da non utilizzare con caldaie a condensazione

| Ø | 180 | 200 | 250 | 300 |
|---|-----|-----|-----|-----|
| H | 190 | 190 | 190 | 190 |



DPA

Adattatore mono maschio-doppia femmina

| Ø | 80 | 100 | 130 | 150 | 180 | 200 | 250 | 300 |
|---|----|-----|-----|-----|-----|-----|-----|-----|
| H | 70 | 70 | 70 | 70 | 70 | 70 | 70 | 70 |



DPAC

Adattatore doppia maschio-mono femmina

| Ø | 80 | 100 | 130 | 150 | 180 | 200 | 250 | 300 |
|---|-----|-----|-----|-----|-----|-----|-----|-----|
| H | 180 | 180 | 180 | 180 | 180 | 180 | 180 | 180 |



DPSC

Scarico condensa verticale.
Raccordo inox con filetto maschio

| Ø | 80 | 100 | 130 | 150 | 180 | 200 | 250 | 300 |
|----|------|------|------|------|------|------|------|------|
| H | 25 | 25 | 25 | 25 | 25 | 25 | 25 | 25 |
| ØF | 3/4" | 3/4" | 3/4" | 3/4" | 3/4" | 3/4" | 3/4" | 3/4" |

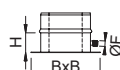

DPSCB

Scarico condensa con basamento.
Raccordo inox con filetto femmina

| Ø | 100 | 130 | 150 | 180 | 200 | 250 | 300 |
|----|------|------|------|------|------|------|------|
| H | 95 | 95 | 95 | 95 | 95 | 95 | 95 |
| B | 250 | 280 | 300 | 330 | 350 | 400 | 450 |
| ØF | 1/2" | 1/2" | 1/2" | 1/2" | 1/2" | 1/2" | 1/2" |

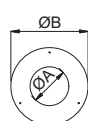

DPRT1

Rosone di copertura tondo.
Accessorio in inox. Installare come rosone estetico di copertura del foro nella muratura

| Ø | 100 | 130 | 150 | 200 |
|----|-----|-----|-----|-----|
| ØA | 159 | 189 | 209 | 259 |
| ØB | 350 | 380 | 400 | 450 |

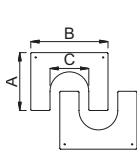

DPRQ2

Rosone di copertura quadro regolabile.
Accessorio in inox. Installare come rosone estetico di copertura del foro nella muratura tetto inclinato

| Ø | 100 | 130 | 150 | 200 |
|---|-----|-----|-----|-----|
| A | 275 | 290 | 300 | 325 |
| B | 350 | 380 | 400 | 450 |
| C | 151 | 181 | 201 | 251 |

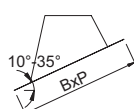

DPG1

Grembialina 1 10°-35° con base in piombo.
Conversa inox con giunzioni saldate. Abbinare alla fascia parapigioggia DPFP

| Ø | 80 | 100 | 130 | 150 | 180 | 200 | 250 | 300 |
|---|-----|-----|------|------|------|------|------|------|
| B | 625 | 625 | 700 | 700 | 700 | 700 | 700 | 800 |
| P | 625 | 625 | 1000 | 1000 | 1000 | 1000 | 1000 | 1000 |



DPFP

Fascia parapigioggia.
Installare sopra le grembialine. Sigillare la fascia sulla tubazione con opportuno mastice a tenuta

| Ø | 80 | 100 | 130 | 150 | 180 | 200 | 250 | 300 |
|----|-----|-----|-----|-----|-----|-----|-----|-----|
| ØA | 130 | 150 | 180 | 200 | 230 | 250 | 300 | 350 |
| ØB | 253 | 273 | 303 | 323 | 353 | 373 | 423 | 473 |

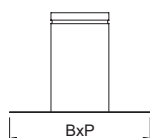

DPG2

Grembialina 2 piana con base in inox.
Conversa inox con giunzioni saldate. Abbinare alla fascia parapigioggia DPFP

| Ø | 80 | 100 | 130 | 150 | 180 | 200 | 250 | 300 |
|---|-----|-----|-----|-----|-----|-----|-----|-----|
| B | 390 | 390 | 485 | 485 | 485 | 485 | 590 | 590 |
| P | 390 | 390 | 485 | 485 | 485 | 485 | 590 | 590 |

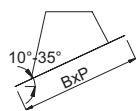

DPG3

Grembialina 3 10°-35° con base in inox.
Conversa inox con giunzioni saldate. Abbinare alla fascia parapigioggia DPFP

| Ø | 80 | 100 | 130 | 150 | 180 | 200 | 250 | 300 |
|---|-----|-----|-----|-----|-----|-----|-----|-----|
| B | 600 | 600 | 650 | 650 | 750 | 750 | 800 | 850 |
| P | 600 | 600 | 650 | 650 | 750 | 750 | 800 | 850 |

Misure tecniche Misure in mm - Riserva di modifiche senza preavviso

DPPS

Piastre supporto da abbinare con DPES o DPSCB

Utilizzare viti e tasselli adeguati alla tipologia di parete o soffitto. Consultare la tabella del carico statico a pag. 56

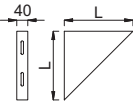

| Ø | 80 | 100 | 130 | 150 | 180 | 200 | 250 | 300 |
|---|-----|-----|-----|-----|-----|-----|-----|-----|
| L | 230 | 250 | 280 | 300 | 330 | 350 | 400 | 450 |

DPMR

Supporto light con piastre.

Utilizzare viti e tasselli adeguati alla tipologia di parete o soffitto. Consultare la tabella del carico statico a pag. 56

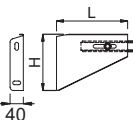

| Ø | 80 | 100 | 130 | 150 | 180 | 200 |
|---|-----|-----|-----|-----|-----|-----|
| H | 165 | 165 | 165 | 165 | 225 | 225 |
| L | 215 | 215 | 215 | 215 | 280 | 280 |

DPPI

Piastra di fissaggio inclinabile.

Utilizzare viti e tasselli adeguati alla tipologia di soletta

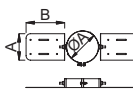

| Ø | 100 | 130 | 150 | 180 | 200 | 250 |
|----|-----|-----|-----|-----|-----|-----|
| ØA | 150 | 180 | 200 | 230 | 250 | 300 |
| A | 150 | 150 | 150 | 150 | 150 | 150 |
| B | 250 | 250 | 250 | 250 | 250 | 250 |

DPFS

Fascia di sicurezza.

Fasce di sicurezza da ordinare



| Ø | 80 | 100 | 130 | 150 | 180 | 200 | 250 | 300 |
|----|-----|-----|-----|-----|-----|-----|-----|-----|
| ØA | 130 | 150 | 180 | 200 | 230 | 250 | 300 | 350 |

Fasce di sicurezza non comprese

DPES

Elemento di supporto

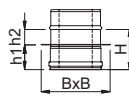

| Ø | 80 | 100 | 130 | 150 | 180 | 200 | 250 | 300 |
|----|-----|-----|-----|-----|-----|-----|-----|-----|
| H | 125 | 125 | 125 | 125 | 125 | 125 | 125 | 125 |
| h1 | 90 | 90 | 90 | 90 | 90 | 90 | 90 | 90 |
| h2 | 35 | 35 | 35 | 35 | 35 | 35 | 35 | 35 |
| B | 230 | 250 | 280 | 300 | 330 | 350 | 400 | 450 |

DPSR

Staffa a parete regolabile.

Utilizzare viti e tasselli adeguati alla tipologia di parete o soffitto. Consultare la tabella del carico statico a pag. 56

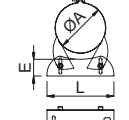

| Ø | 80 | 100 | 130 | 150 | 180 | 200 | 250 | 300 |
|----|-------|-------|-------|-------|-------|-------|-------|-------|
| ØA | 130 | 150 | 180 | 200 | 230 | 250 | 300 | 350 |
| E | 30-55 | 55-95 | 55-95 | 55-95 | 55-95 | 55-95 | 55-95 | 55-95 |
| L | 142 | 202 | 202 | 202 | 202 | 202 | 202 | 202 |

DPCT

Fascia per 3 cavi tiranti.

Permette di fissare con cavi il tratto terminale a sbalzo. Utilizzare solo cavi e sistemi di fissaggio in acciaio inox (non forniti con l'articolo)



| Ø | 100 | 130 | 150 | 180 | 200 | 250 | 300 |
|----|-----|-----|-----|-----|-----|-----|-----|
| ØA | 150 | 180 | 200 | 230 | 250 | 300 | 350 |

