

## Misure tecniche

Misure in mm - Riserva di modifiche senza preavviso

### IDCA

Cappa antivento a botte

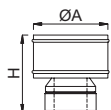

Ø	350	400
ØA	650	700
H	330	330

### IDVE

Cappa per ventilazione

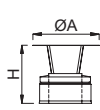

Ø	350	400	450	500	600
ØA	700	800	800	800	800
H	300	300	320	320	320

### IDTC

Terminale conico

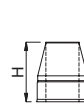

Ø	350	400	450	500	600
H	180	180	180	180	180

### ID100 / ID50 / ID25

Diritto 940/440/190 mm utili

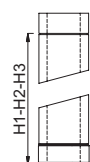

Ø	350	400	450	500	600
H1	940	940	940	940	940
H2	440	440	440	440	440
H3	190	190	190	190	190

### IDR

Elemento regolabile 340-500 mm.  
Elemento telescopico che consente di coprire misure variabili fino a 160 mm. Se installato in verticale inserire un supporto sopra l'elemento

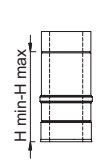

Ø	350	400	450	500	600
H min	340	340	340	340	340
H max	500	500	500	500	500

### IDT87 / IDT90

Elemento a T 87°/ 90°

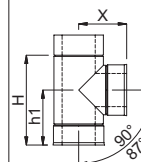

Ø	350	400	450	500	600
H	515	565	615	665	765
h1	280	300	325	350	395
X	300	325	350	375	430

### IDT45

Elemento a T 45°

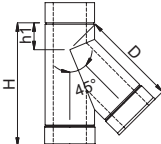

Ø	350	400	450	500	600
H	725	795	865	940	1080
h1	135	145	155	165	185
D	595	655	715	775	895

### IDG87

Gomito a 87°

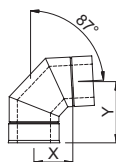

Ø	350	400
X	250	260
Y	320	335

### IDG45

Gomito a 45°

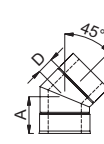

Ø	350	400	450	500	600
A	165	175	185	195	215
D	105	115	125	135	155

### IDG30

Gomito a 30°

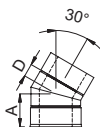

Ø	350	400	450	500	600
A	135	140	145	155	165
D	75	80	85	95	105

### IDIT

Ispezione con tappo.  
Per combustibili gassosiliquidi

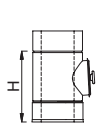

Ø	350	400	450	500	600
H	270	440	440	440	440

### IDTAPPO

Tappo cieco



Ø	350	400	450	500	600
H	40	40	40	40	40

### IDPF

Prelievo fumi.  
Elemento provvisto di due prese fumi da 1/2"

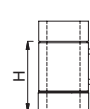

Ø	350	400	450	500	600
H	270	270	270	270	270

### IDPA

Prelievo fumi ARPA con flange

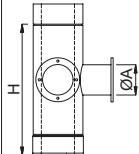

Ø	350	400	450	500	600
H	940	940	940	940	940
ØA	110	110	110	110	110

### IDA

Adattatore mono maschio-doppia femmina



Ø	350	400	450	500	600
H	40	40	40	40	40

### IDAC

Adattatore doppia maschio-mono femmina



Ø	350	400	450	500	600
H	160	160	160	160	160

### IDAF

Adattatore flangiato.  
Flangia su misura

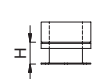

Ø	350	400	450	500	600
H	160	160	160	160	160

### IDSC

Fascia parapioggia.  
Raccordo inox con filetto maschio



Ø	350	400	450	500	600
A	100	100	100	100	100
D	1/2"	1/2"	1/2"	1/2"	1/2"

### IDSCB

Scarico condensa con basamento regolabile. L'altezza della piastra si può portare a misura da un min. di 125 mm ad un max di 1065 mm

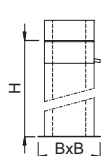

Ø	350	400	450	500	600
H	1065	1065	1065	1065	1065
B	445	495	545	595	695
ØF	25	25	25	25	25

### IDG1

Grembialina 1 5°-25° con base in piombo.  
Abbinare alla fascia parapioggia IDFP

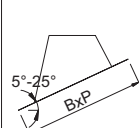

Ø	350	400	450	500	600
B	750	1000	1100	1200	1400
P	1000	1200	1200	1300	1400

### IDFP

Fascia parapioggia.  
Installare sopra le grembialine. Sigillare la fascia sulla tubazione con opportuno mastice a tenuta

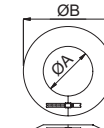

Ø	350	400	450	500	600
ØA	400	450	500	550	650
ØB	530	580	630	680	780

### IDG2

Grembialina 2 piana con base inox.  
Installare sopra le grembialine.  
Abbinare alla fascia parapioggia IDFP

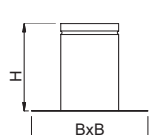

Ø	350	400	450	500	600
B	690	740	790	845	945

### IDMR

Supporto con piastre. Piastra regolabile. Utilizzare viti e tasselli adeguati alla tipologia di parete

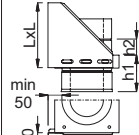

Ø	350	400	450	500	600
h1	110	110	110	110	110
h2	50	50	50	50	50
L	460	510	560	610	710
B	525	575	625	675	775
P	445	495	545	595	695

### IDSR

Staffa a parete. Utilizzare viti e tasselli adeguati alla tipologia di parete

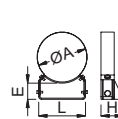

Ø	350	400	450	500	600
ØA	400	450	500	550	650
E	50-80	50-80	50	50	50
L	345	360	445	445	500
H	70	70	110	110	110